

Soils Map

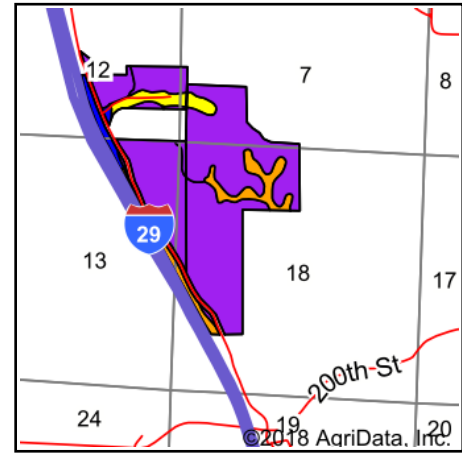
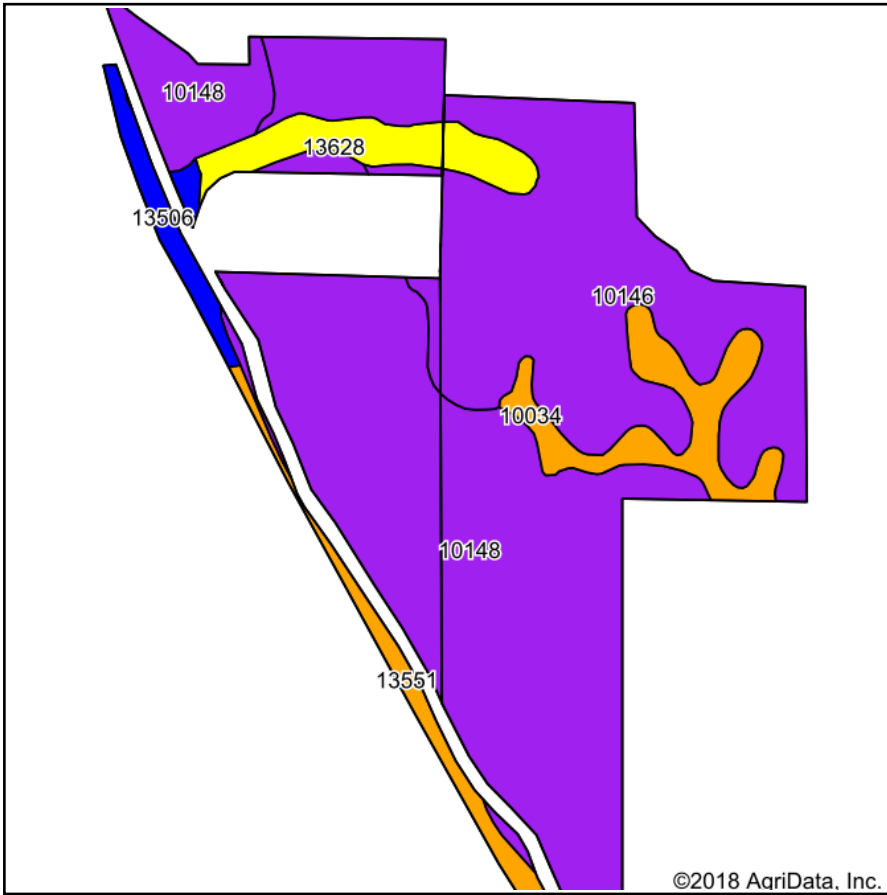

State: **Missouri**
 County: **Atchison**
 Location: **18-65N-41W**
 Township: **Clay**
 Acres: **291.85**
 Date: **6/20/2018**

Maps Provided By:

 CUSTOMIZED ONLINE MAPPING
 © Agridata, Inc. 2018 www.AgridataInc.com



Soils data provided by USDA and NRCS.

©2018 AgriData, Inc.

Area Symbol: MO005, Soil Area Version: 19

Code	Soil Description	Acres	Percent of field	Non-Irr Class Legend	Non-Irr Class *c	Irr Class *c	Common bermudagrass	Orchardgrass red clover	Tall fescue	Warm season grasses	Alfalfa hay	Caucasian bluestem	NCCPI Overall	NCCPI Corn	NCCPI Small Grains	NCCPI Soybean
10148	Timula-Hamburg silt loams, 30 to 90 percent slopes	142.96	49.0%		Vlle		5	5	5	5	5	5	15	15	14	
10146	Timula silt loam, 25 to 60 percent slopes	102.46	35.1%		Vlle		7	7	7	8	7	8	16	16	15	
10034	Ida silt loam, 9 to 14 percent slopes, eroded	17.00	5.8%		Ille								66	58	41	
13628	Napier-Gullied land complex, 5 to 14 percent slopes	13.93	4.8%		IVe	Ille							31	5	0	
13551	McPaul silt loam, 0 to 2 percent slopes, occasionally flooded	8.08	2.8%		Illw		8	9	8	10			73	71	63	
13506	Blencoe silty clay loam, clayey substratum, 0 to 2 percent slopes, rarely flooded	7.42	2.5%		Ilw	Ilw	8	7	8	9			56	54	43	
Weighted Average							5.3	5.3	5.3	5.8	4.9	5.3	21.7	19.9	17.3	1

*c: Using Capabilities Class Dominant Condition Aggregation Method

Soils data provided by USDA and NRCS.