

Soils Map

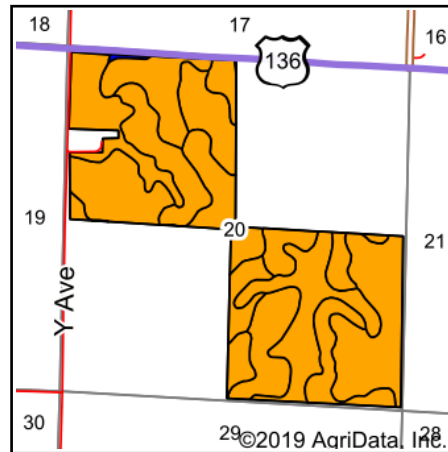

State: **Missouri**
 County: **Atchison**
 Location: **20-65N-38W**
 Township: **Colfax**
 Acres: **162.12**
 Date: **7/5/2019**

Maps Provided By: 
 © AgriData, Inc. 2019 www.AgriDataInc.com

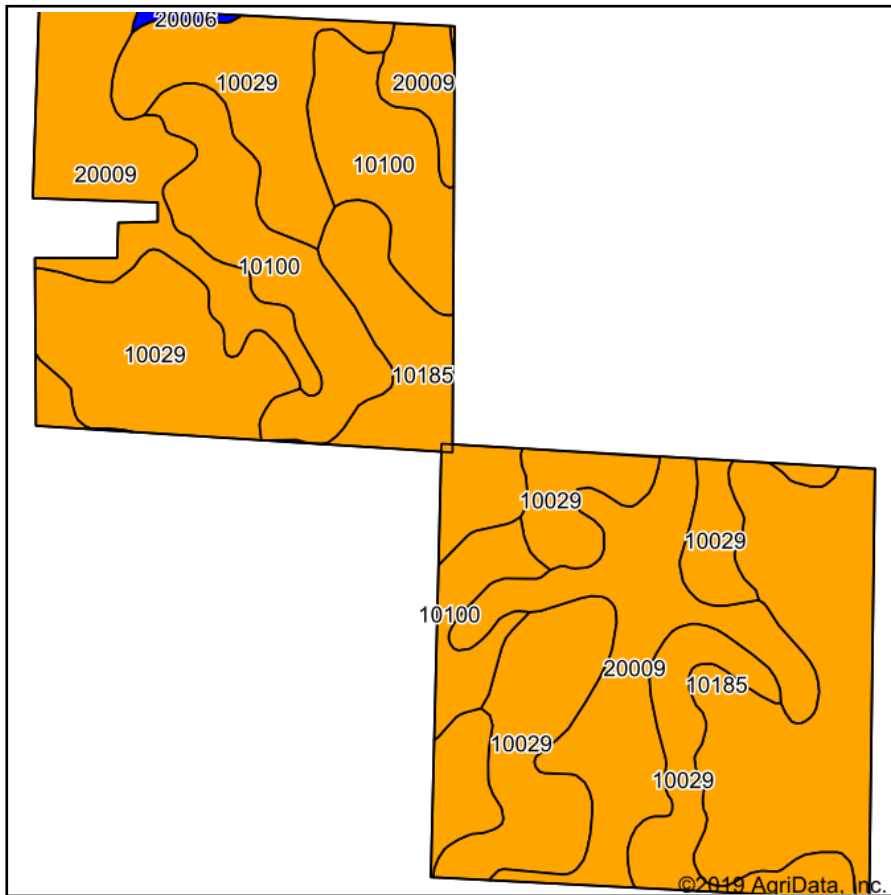

Soils data provided by USDA and NRCS.

| Area Symbol: MO005. Soil Area Version: 20 | | | | | | | | | | | | | | | |
|---|--|--------|------------------|----------------------|------------------|--------------------|---------------------|-------------|-------------------------|-------------|---------------------|------------------|----------------|-----------------------|-------------------|
| Code | Soil Description | Acres | Percent of field | Non-Irr Class Legend | Non-Irr Class *c | Caucasian bluestem | Common bermudagrass | Alfalfa hay | Orchardgrass red clover | Tall fescue | Warm season grasses | *n NCCPI Overall | *n NCCPI Corn | *n NCCPI Small Grains | *n NCCPI Soybeans |
| 10185 | Shelby clay loam, deep loess, 9 to 14 percent slopes, eroded | 76.32 | 47.1% | | IIle | | | | | | | 68 | 68 | 43 | 53 |
| 20009 | Sharpsburg silty clay loam, 5 to 9 percent slopes, eroded | 72.98 | 45.0% | | IIle | | | | | | | 71 | 71 | 48 | 63 |
| 10100 | Marshall silty clay loam, 9 to 14 percent slopes, eroded | 52.93 | 32.6% | | IIle | | | | | | | 76 | 76 | 48 | 59 |
| 20006 | Sharpsburg silty clay loam, 2 to 5 percent slopes | 0.86 | 0.5% | | Ile | | | | | | | 93 | 93 | 65 | 77 |
| 10029 | Higginsville silty clay loam, 5 to 9 percent slopes, eroded | -40.97 | -25.3% | | IIle | 8 | 7 | 7 | 7 | 7 | 8 | 59 | 59 | 37 | 57 |
| Weighted Average | | | | | | -2 | -1.8 | -1.8 | -1.8 | -1.8 | -2 | *n 74.4 | *n 74.4 | *n 48.5 | *n 58.6 |

*n: The aggregation method is "Weighted Average using major components"

*c: Using Capabilities Class Dominant Condition Aggregation Method

Soils data provided by USDA and NRCS.