

Soils Map

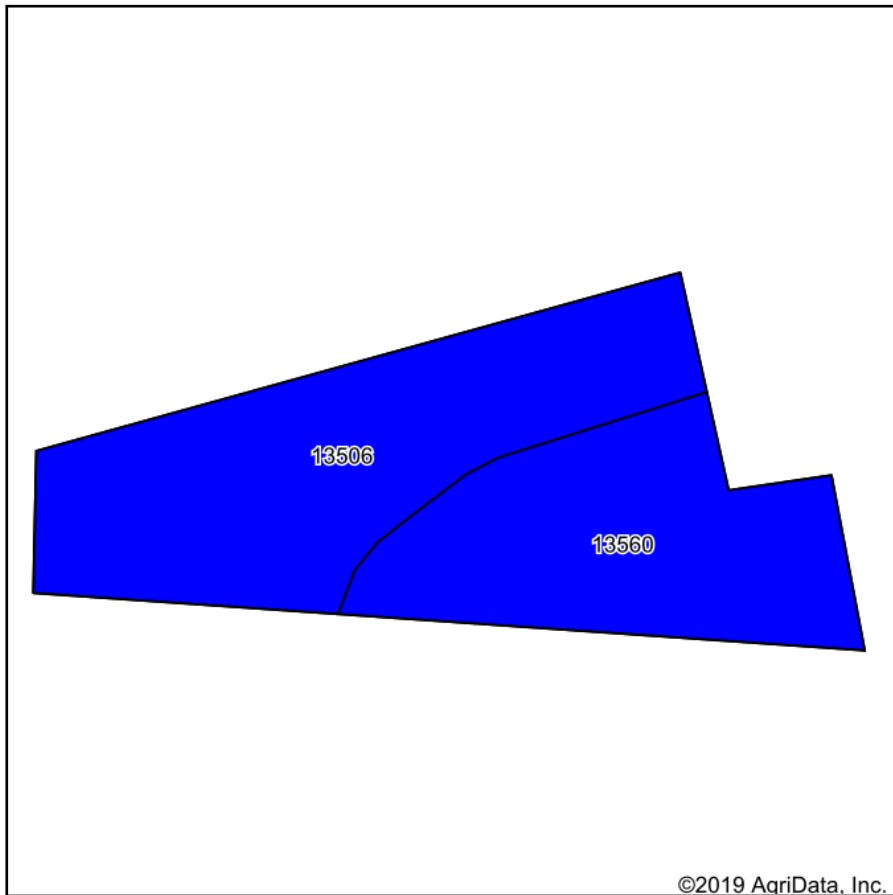

Soils data provided by USDA and NRCS.

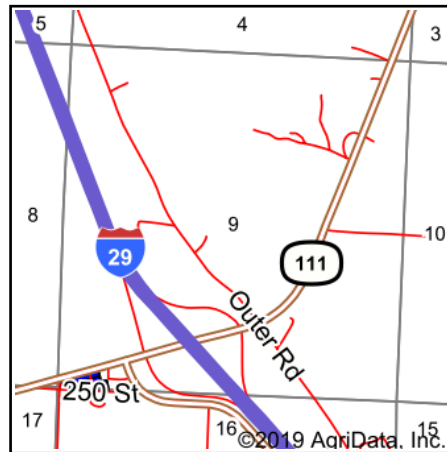

State: **Missouri**
 County: **Atchison**
 Location: **9-64N-41W**
 Township: **Clay**
 Acres: **3.66**
 Date: **7/1/2019**

Maps Provided By:

 CUSTOMIZED ONLINE MAPPING
 © AgriData, Inc. 2019 www.AgriDataInc.com



Area Symbol: MO005. Soil Area Version: 20														
Code	Soil Description	Acres	Percent of field	Non-Irr Class Legend	Non-Irr Class *c	Irr Class *c	Common bermudagrass	Orchardgrass red clover	Tall fescue	Warm season grasses	*n NCCPI Overall	*n NCCPI Corn	*n NCCPI Small Grains	*n NCCPI Soybeans
13506	Blencoe silty clay loam, clayey substratum, 0 to 2 percent slopes, rarely flooded	2.09	57.1%		Ilw	Ilw	8	7	8	9	56	54	43	56
13560	Napier silt loam, 2 to 5 percent slopes	1.57	42.9%		Ile						87	87	69	85
Weighted Average							4.6	4	4.6	5.1	*n 69.3	*n 68.2	*n 54.2	*n 68.4

*n: The aggregation method is "Weighted Average using major components"

*c: Using Capabilities Class Dominant Condition Aggregation Method

Soils data provided by USDA and NRCS.