

Soils Map

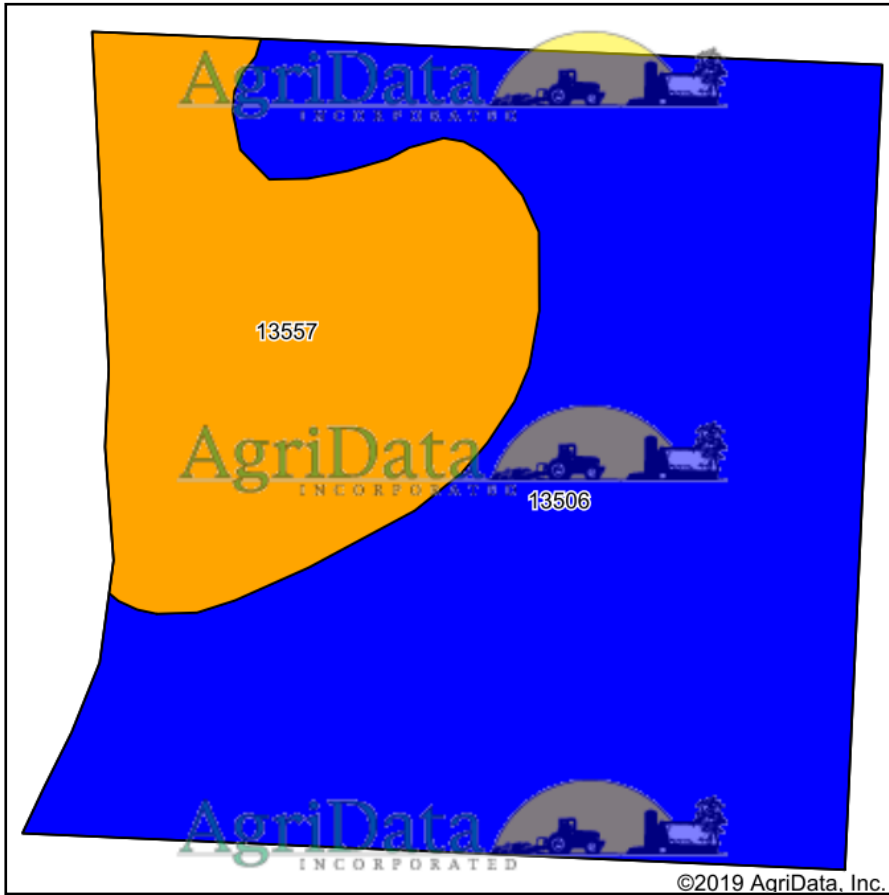

Soils data provided by USDA and NRCS.

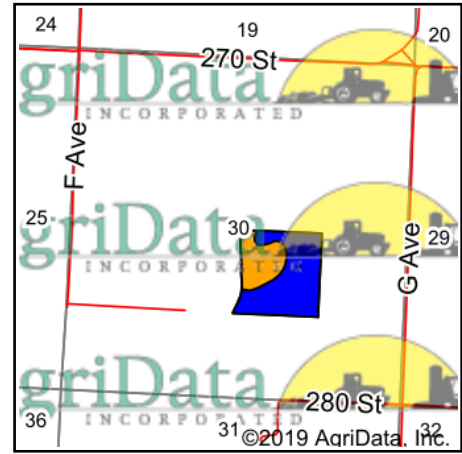

State: **Missouri**
 County: **Atchison**
 Location: **30-64N-41W**
 Township: **Benton**
 Acres: **38**
 Date: **11/20/2019**

Maps Provided By:

 CUSTOMIZED ONLINE MAPPING
 © AgriData, Inc. 2019 www.AgriDataInc.com



| Area Symbol: MO005. Soil Area Version: 21 | | | | | | | | | | | | | | |
|---|---|-------|------------------|----------------------|------------------|--------------|---------------------|-------------------------|-------------|---------------------|------------------|----------------|-----------------------|-------------------|
| Code | Soil Description | Acres | Percent of field | Non-Irr Class Legend | Non-Irr Class *c | Irr Class *c | Common bermudagrass | Orchardgrass red clover | Tall fescue | Warm season grasses | *n NCCPI Overall | *n NCCPI Corn | *n NCCPI Small Grains | *n NCCPI Soybeans |
| 13506 | Blencoe silty clay loam, clayey substratum, 0 to 2 percent slopes, rarely flooded | 26.89 | 70.8% | | Ilw | Ilw | 8 | 7 | 8 | 9 | 56 | 54 | 43 | 56 |
| 13557 | Moville silt loam, 0 to 2 percent slopes, rarely flooded | 11.11 | 29.2% | | Illw | Ilw | 8 | 9 | 8 | 10 | 69 | 69 | 46 | 55 |
| Weighted Average | | | | | | | 8 | 7.6 | 8 | 9.3 | *n 59.8 | *n 58.4 | *n 43.9 | *n 55.7 |

*n: The aggregation method is "Weighted Average using major components"

*c: Using Capabilities Class Dominant Condition Aggregation Method

Soils data provided by USDA and NRCS.